

For Sale

\$ 485,000.00 USD

Toa Baja
 Levittown
 Listing ID 2231057092

Opportunity Awaits: Prime Mixed-Use Multifamily Fixer Upper in High-Traffic Location Unlock the potential of this strategically located mixed-use multifamily property, perfectly positioned on the bustling main road connecting Sabana Seca to Levittown. With high visibility and strong traffic flow, this property is a golden opportunity for investors, owner-occupiers, or entrepreneurs seeking to establish a thriving business presence. Property Overview: Lot Size: 606 m² Building Size: 3,360 sq ft First Level – Commercial Spaces: Office space with a convenient half bathroom Independent 1-bedroom apartment featuring a full bathroom and laundry area Garage-style commercial space equipped with a rolling door and half bathroom These spaces are perfect for short- or long-term rentals or can accommodate multiple business ventures. Second Level – Main Residence: 3 spacious bedrooms and 2 full bathrooms Open and airy living and dining areas Front and rear balconies for added outdoor enjoyment Additional Features: Ample parking available for 10+ vehicles Fully fenced for privacy and security Prime location with excellent exposure Versatile functionality: suitable for residential, commercial, or mixed-use Images include AI-generated virtual staging to help visualize potential uses and layouts. Whether you're looking to invest, live, or launch a business, this property offers unparalleled flexibility and opportunity. Don't miss out on this ideal investment in a prime location.

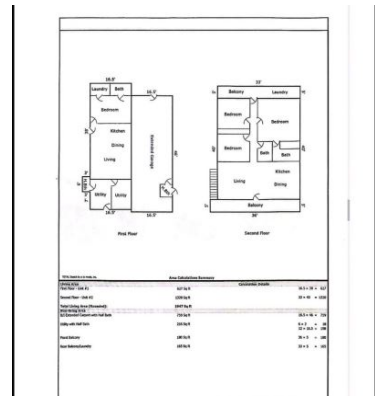

SEE THIS PROPERTY IN MAP

THIS PROPERTY IS PROMOTED BY RE/MAX DORADO REALTY

remaxdorado@gmail.com

http://remax-central.gt

RE/MAX DORADO REALTY

C.C. Los Faroles, Local 1 Km. 32.3

Sn. Lucas Sacatepéquez, Guatemala, C.A.



Each office is independently owned and operated